



## "Basic" ball valve

### Female threaded outlet - PE - Basic System ITEM 208

| Ref.    | Description                    | Net W. | Vol. (m <sup>3</sup> ) | Gross W. | Batch |
|---------|--------------------------------|--------|------------------------|----------|-------|
| 1011092 | VALVULA ENLACE R/HEMBRA 1/2"   | 0,164  | 0,01553                | 6,88     | 40    |
| 1011093 | VALVULA ENLACE R/HEMBRA 3/4"   | 0,208  | 0,02244                | 8,83     | 40    |
| 1011094 | VALVULA ENLACE R/HEMBRA 1"     | 0,358  | 0,03129                | 11,32    | 30    |
| 1011095 | VALVULA ENLACE R/HEMBRA 1 1/4" | 0,610  | 0,03129                | 12,78    | 20    |
| 1011096 | VALVULA ENLACE R/HEMBRA 1 1/2" | 0,880  | 0,03129                | 13,78    | 15    |
| 1011097 | VALVULA ENLACE R/HEMBRA 2"     | 1,370  | 0,03682                | 14,25    | 10    |
| 1011098 | VALVULA ENLACE R/HEMBRA 2 1/2" | 2,777  | 0,03129                | 11,68    | 4     |
| 1011099 | VALVULA ENLACE R/HEMBRA 3"     | 4,491  | 0,02244                | 9,47     | 2     |
| 1011692 | V E. SISTEMA IMPLEX S R/H 4"   | 6,168  | 0,04460                | 13,07    | 2     |



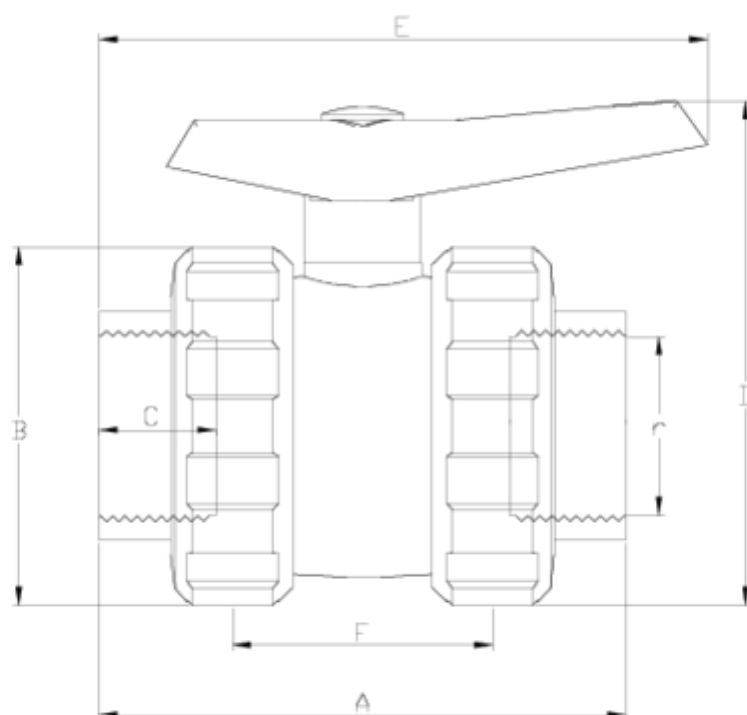

## ITEM 208 | Female threaded outlet - PE - Basic System

| CÓDIGO | r      | DN  | PESO (g) | A   | B   | C  | D   | E   | F   | PN   | TIPO ROSCA |
|--------|--------|-----|----------|-----|-----|----|-----|-----|-----|------|------------|
| 11092  | 1/2"   | 15  | 154      | 86  | 51  | 17 | 74  | 88  | 44  | PN16 | BSP        |
| 11093  | 3/4"   | 20  | 194      | 99  | 58  | 20 | 80  | 94  | 49  | PN16 | BSP        |
| 11094  | 1"     | 25  | 315      | 122 | 68  | 23 | 103 | 138 | 66  | PN16 | BSP        |
| 11095  | 1 1/4" | 32  | 540      | 131 | 84  | 26 | 125 | 160 | 71  | PN16 | BSP        |
| 11096  | 1 1/2" | 40  | 816      | 155 | 99  | 33 | 138 | 170 | 75  | PN16 | BSP        |
| 11097  | 2"     | 50  | 1304     | 180 | 116 | 29 | 177 | 207 | 89  | PN16 | BSP        |
| 11098  | 2 1/2" | 65  | 2700     | 202 | 150 | 33 | 215 | 260 | 119 | PN10 | BSP        |
| 11099  | 3"     | 80  | 4340     | 232 | 178 | 36 | 251 | 271 | 140 | PN10 | BSP        |
| 11692  | 4"     | 100 | 5840     | 267 | 210 | 42 | 307 | 426 | 155 | PN10 | BSP        |



## PRODUCT DOCUMENTS



## PRODUCT CERTIFICATES



## COMPANY CERTIFICATES

